

FUEL TANK AND LINE COMPONENTS

881Y5-04

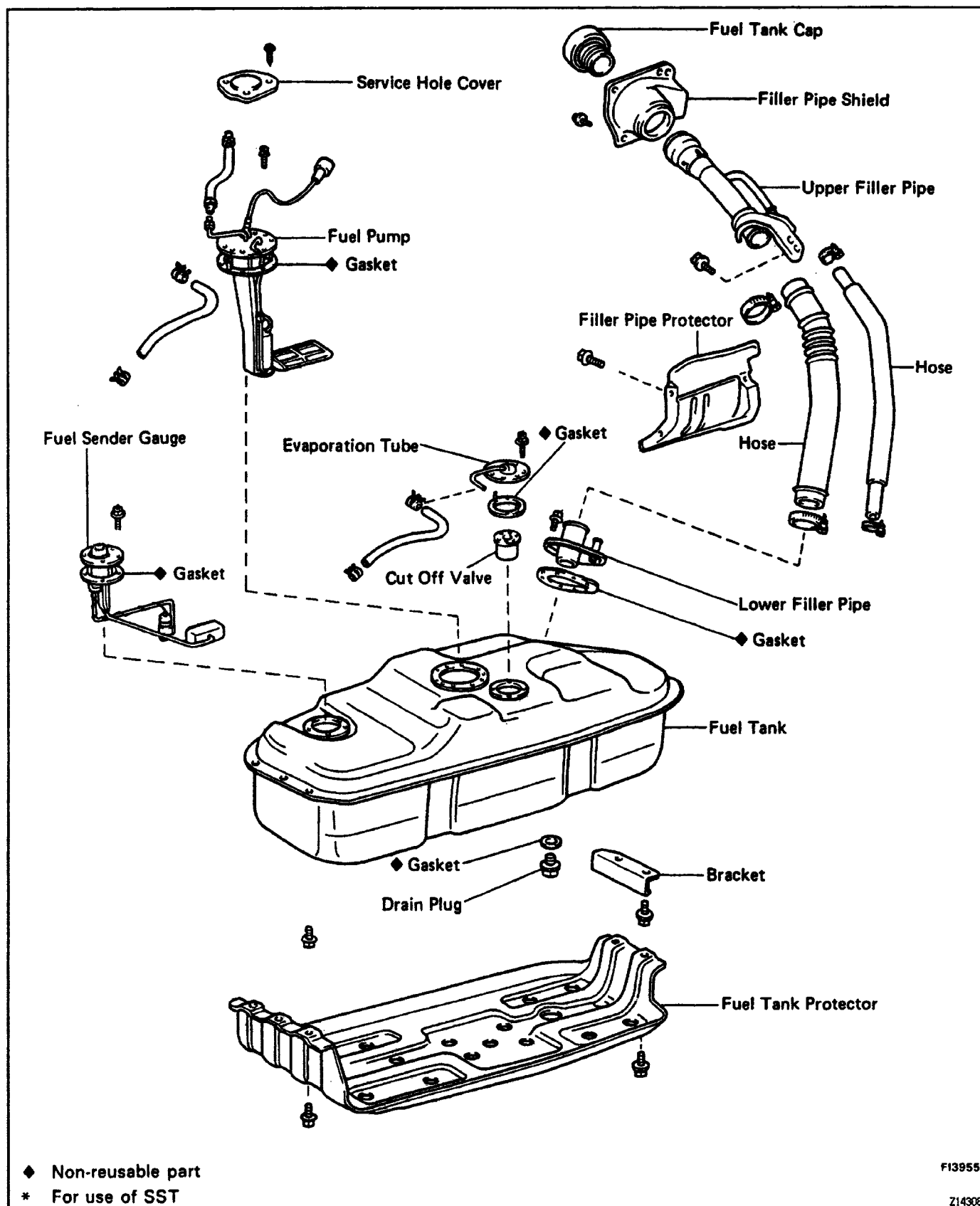

F13955

Z14308

PRECAUTIONS

1. Always use new gaskets when replacing the fuel tank or component part.
2. Apply the proper torque to all parts tightened.

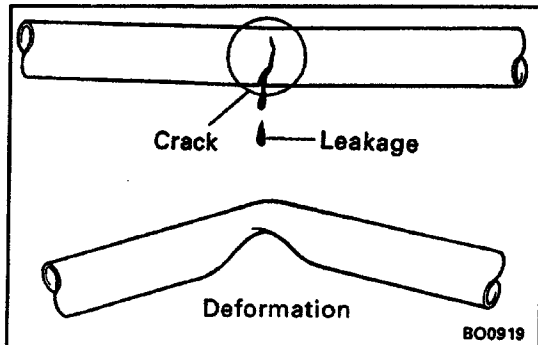

FUEL LINES AND CONNECTIONS INSPECTION

- (a) Inspect the fuel lines for cracks or leakage, and all connections for deformations.
- (b) Inspect the fuel tank vapor vent system hoses and connections for looseness, sharp bends or damage.
- (c) Inspect the fuel tank for deformations, cracks or fuel leakage.
- (d) Inspect the filler neck for damage or fuel leakage.
- (e) Hose and tube connections are as shown in the illustration.

If a problem is found, repair or replace the parts as necessary.

