

# ABS ACTUATOR

## ABS ACTUATOR REMOVAL

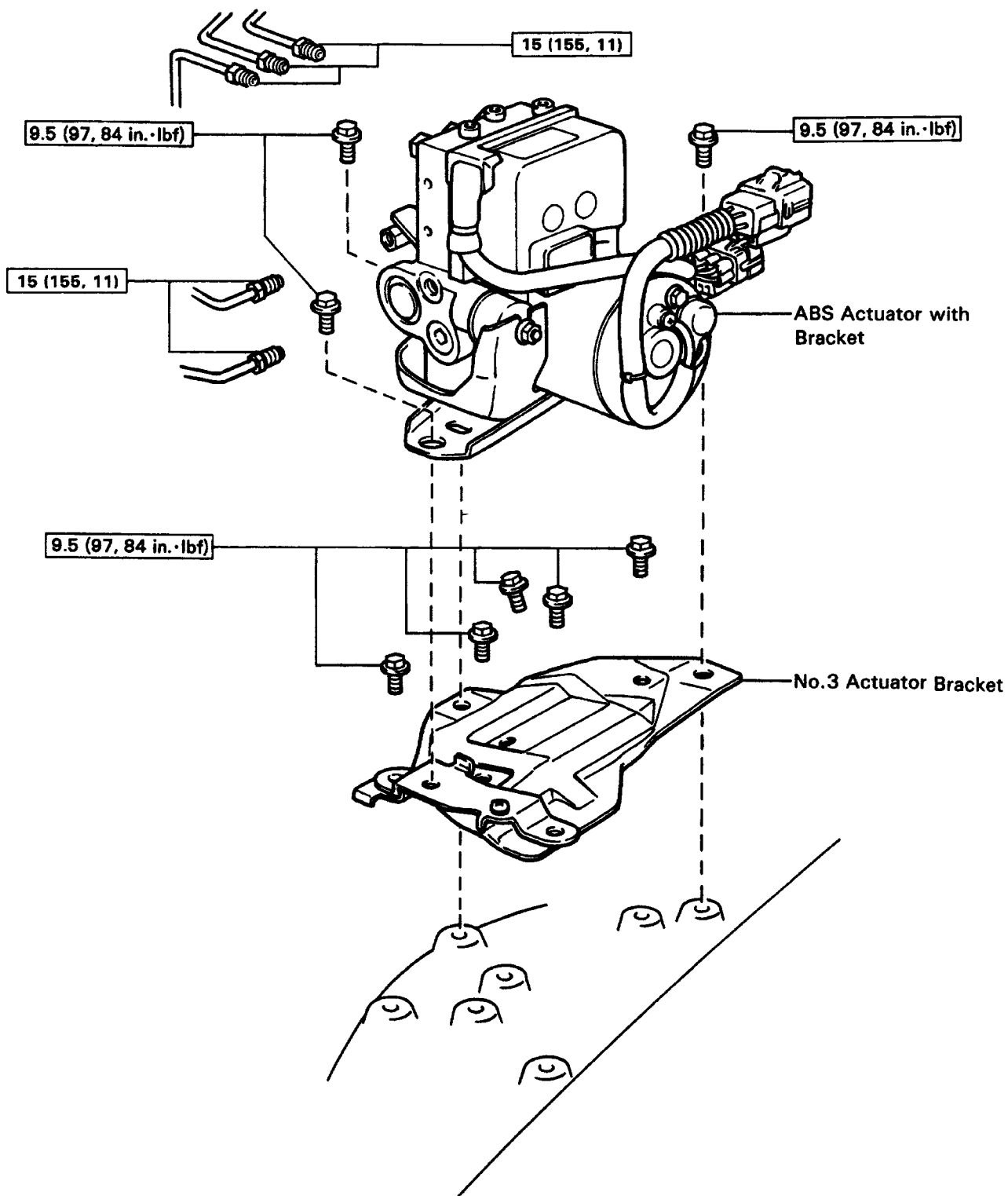
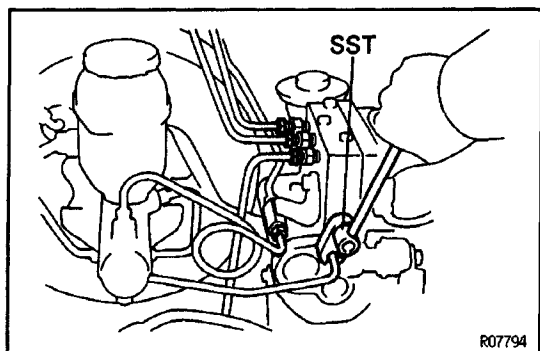

N·m (kgf·cm, ft·lbf) : Specified torque

**1. DISCONNECT 2 CONNECTOR FROM ACTUATOR****2. DISCONNECT BRAKE LINES**

Using SST, disconnect the brake lines from the ABS actuator.

SST 09023-00100

**3. REMOVE ABS ACTUATOR ASSEMBLY**

Remove the 3 bolts and ABS actuator assembly from No.3 actuator bracket.

**4. REMOVE NO.3 ACTUATOR BRACKET**

Remove the 5 bolts and No.3 actuator bracket.

**ABS ACTUATOR INSTALLATION****1. INSTALL NO.3 ACTUATOR BRACKET**

Install the 5 bolts and No.3 actuator bracket.

**Torque: 9.5 N-m (97 kgf-cm, 84 in.-lbf)**

**2. INSTALL ABS ACTUATOR ASSEMBLY**

Install the 3 bolts and ABS actuator assembly from No.3 actuator bracket.

**Torque: 9.5 N-m (97 kgf-cm, 84 in.-lbf)**

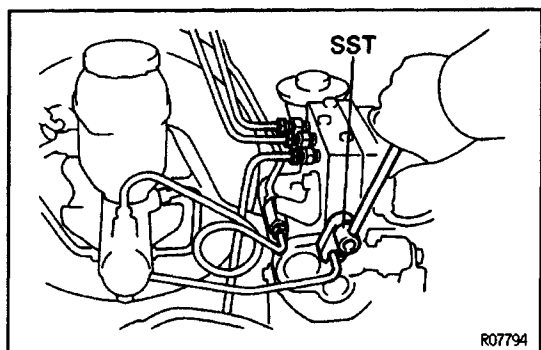
**3. CONNECT BRAKE LINES**

Using SST, connect the brake lines to the ABS actuator.

SST 09023 - 00100

**Torque: 15 N-m (155 kgf-cm, 11 ft-lbf)**

**4. CONNECT 2 CONNECTOR FROM ACTUATOR****5. BLEED BRAKE SYSTEM (See page [BR-8](#))**

## ABS ACTUATOR DISASSEMBLY AND ASSEMBLY

Disassemble and assemble the parts, as shown.

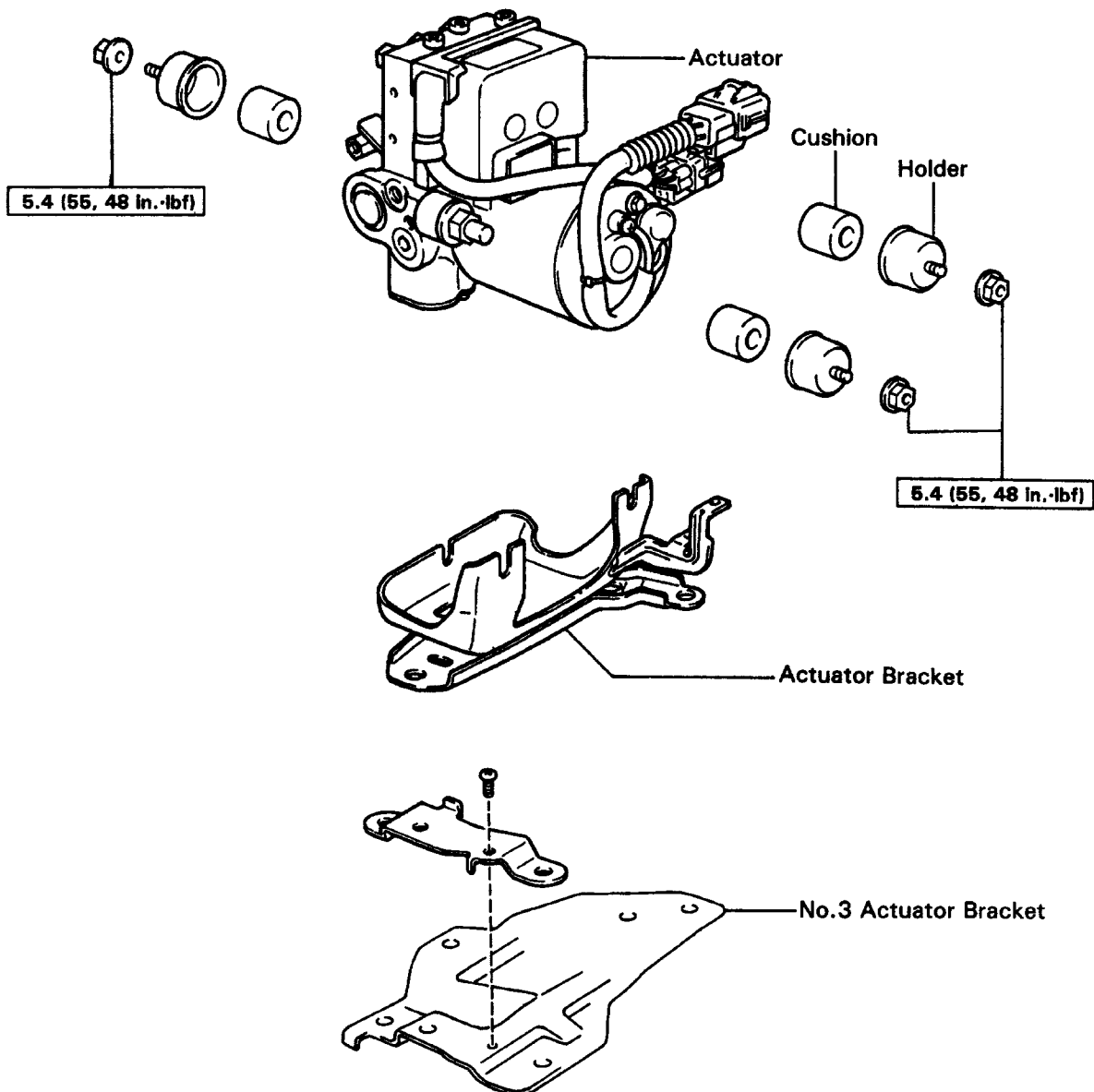

**N·m (kgf·cm, ft·lbf) : Specified torque**

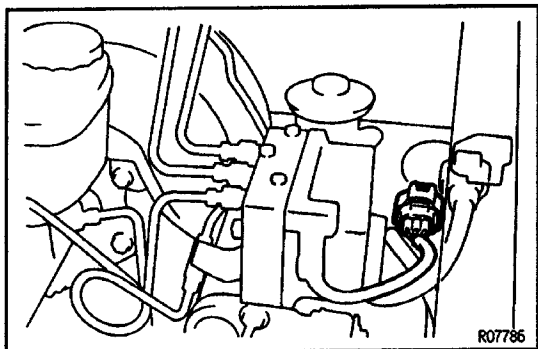

## ABS ACTUATOR INSPECTION

### 1. INSPECT BATTERY POSITIVE VOLTAGE

Battery positive voltage:

10-14 V

### 2. DISCONNECT CONNECTORS

(a) Disconnect the connector from the actuator.

(b) Disconnect the 2 connectors from the control relay.

### 3. CONNECT ACTUATOR CHECKER (SST) TO ACTUATOR

(a) Connect the actuator checker (SST) to the actuator, control relay and body side wire harness through the sub-wire harness C (SST) and E (SST), as shown.  
SST 09990-00150, 09990-00200, 09990-00210

(b) Connect the red cable of the checker to the battery positive (+) terminal and black cable to the negative (-) terminal. Connect the black cable of the sub-wire harness to the battery negative (-) terminal or body ground.

(c) Place "SHEET L" (SST) on the actuator checker.  
SST 09990-00370

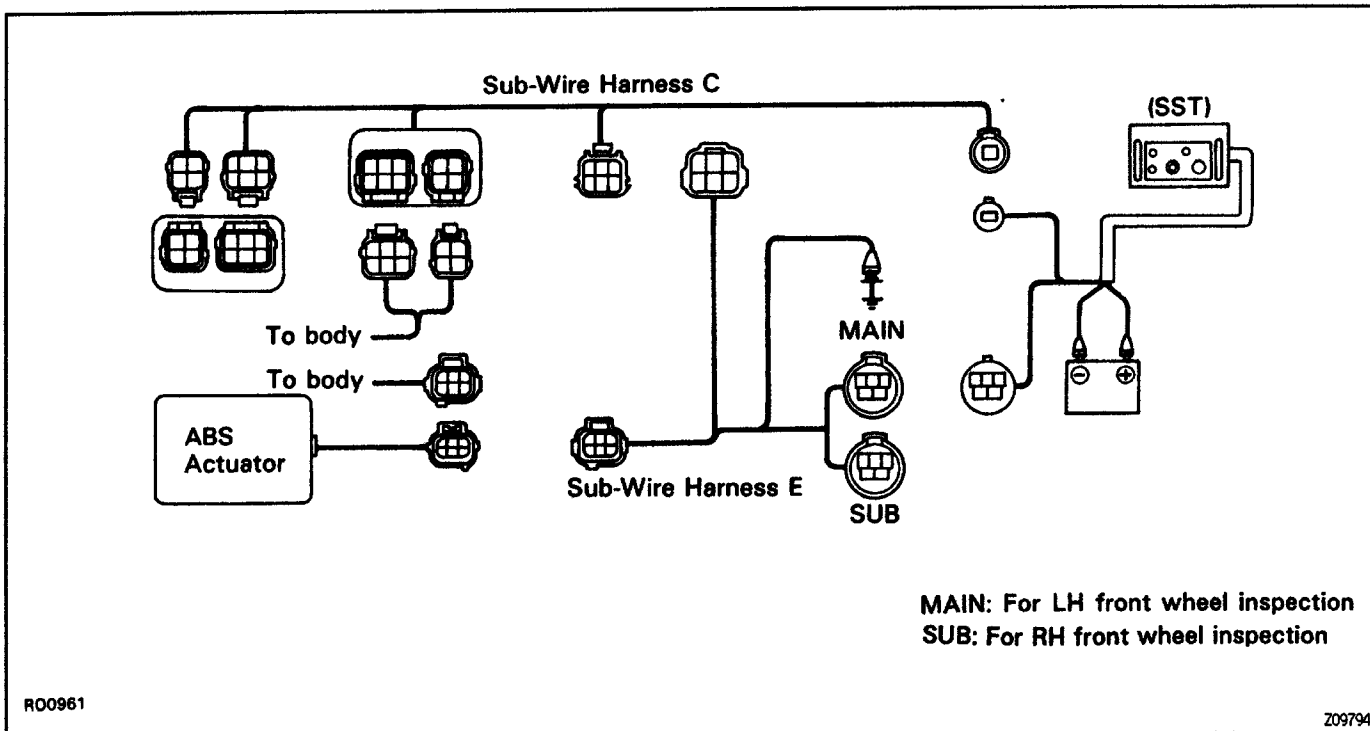
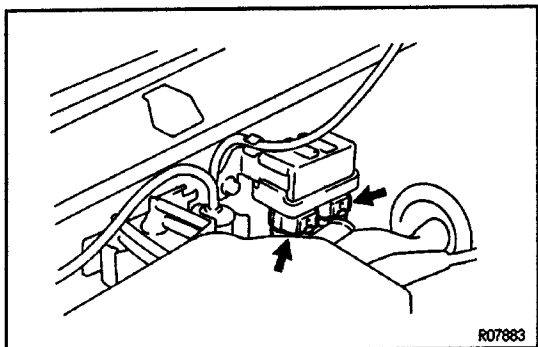

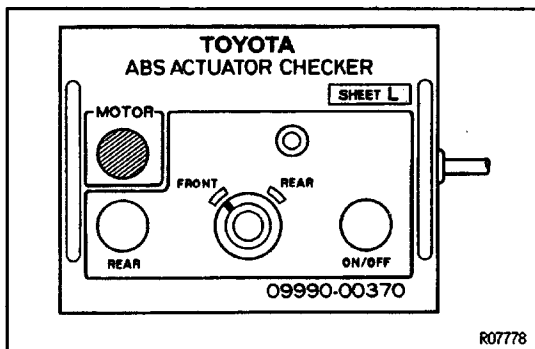

#### 4. INSPECT BRAKE ACTUATOR OPERATION

- (a) Start the engine, and run it at idle.
- (b) Turn the selector switch of the actuator checker to "FRONT" position.
- (c) Push and hold in the MOTOR SWITCH for a few seconds.
- (d) Depress the brake pedal and hold it until the step (g) is completed.

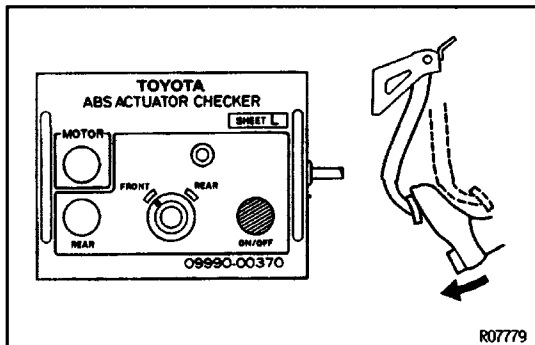

- (e) Push the POWER SWITCH, and check that the brake pedal does not go down.

**NOTICE: Do not keep the POWER SWITCH pushed down for more than 10 seconds.**

- (f) Release the switch, and check that the pedal goes down.

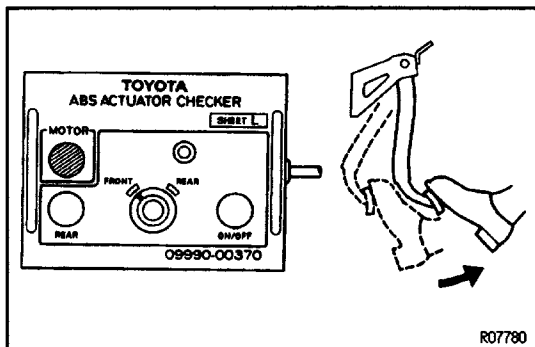

- (g) Push and hold in the MOTOR switch for a few seconds, and check that the pedal returns.
- (h) Release the brake pedal.

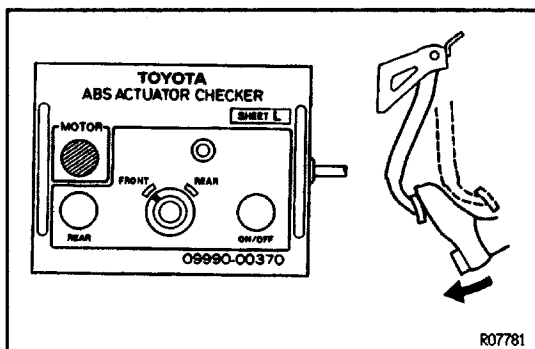

- (i) Push and hold in the MOTOR switch for a few seconds.
- (j) Depress the brake pedal and hold it for about 15 seconds. As you hold the pedal down, push the MOTOR SWITCH for a few seconds. Check that the brake pedal does not pulsate.
- (k) Release the brake pedal.

#### 5. INSPECT FOR OTHER WHEELS

- (a) Change the connection of the actuator checker(SST) to the sub-wire harness E(SST) – from the subwire harness MAIN connector to the SUB connector, or vice versa.
- (b) Repeating
- (c) to (j) of the step 4, check the actuator operation same way.

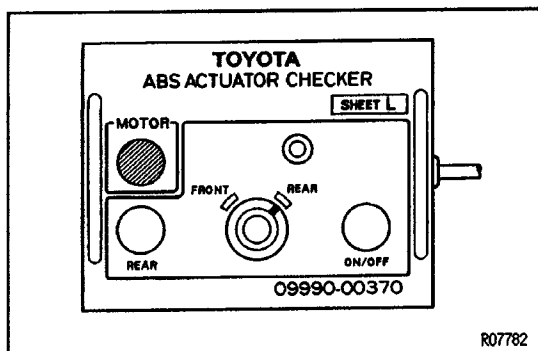

## 6. INSPECT FOR REAR WHEEL

- (a) Turn the selector switch to the "REAR" position.
- (b) Push and hold in the MOTOR SWITCH for a few seconds.
- (c) Depress the brake pedal and hold it until the step (g) is completed.

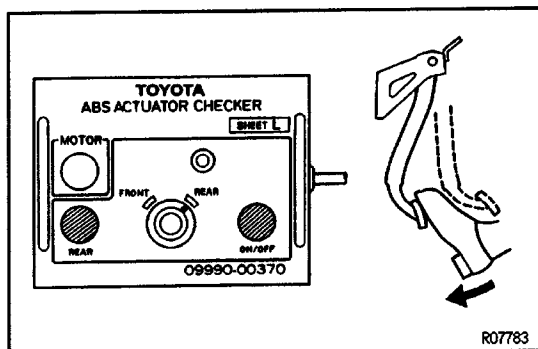

- (d) Push the REAR switch while pressing the POWER switch, and check that the brake pedal cannot be depressed.

**NOTICE: Do not keep the POWER SWITCH pushed down for more than 10 seconds.**

- (e) Release the REAR switch then the POWER switch, and check that the brake pedal can be depressed.

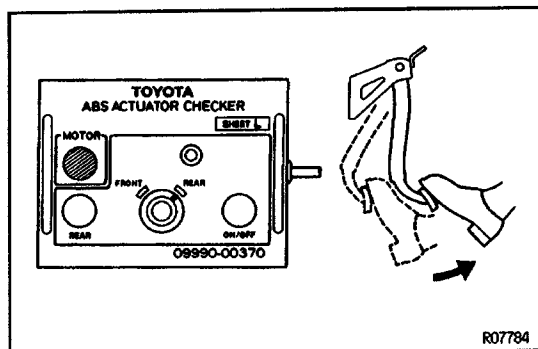

- (f) Push and hold in the MOTOR switch for a few seconds, and check that the pedal returns.
- (g) Release the brake pedal.

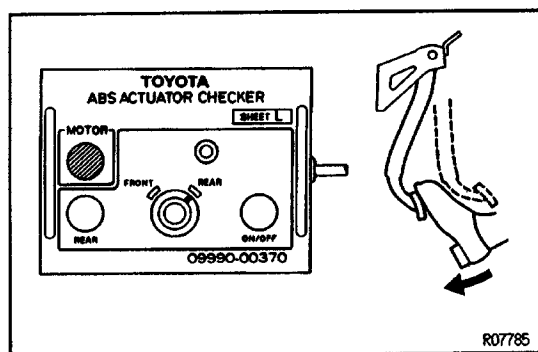

- (h) Push and hold in the MOTOR switch for a few seconds.
- (i) Depress the brake pedal and hold it for about 15 seconds. As you hold the pedal down, push the MOTOR SWITCH for a few seconds. Check that the brake pedal does not pulsate.
- (j) Release the brake pedal.

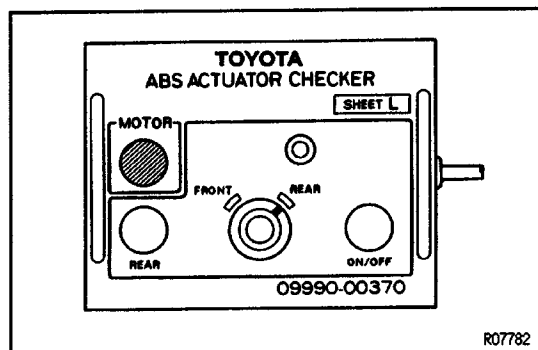

## 7. PUSH MOTOR SWITCH

- (a) Push and hold in the MOTOR switch for a few seconds.
- (b) Stop the engine.

## 8. DISCONNECT ACTUATOR CHECKER (SST) FROM ACTUATOR

Disconnect the actuator checker (SST) and sub-wire harness (SST) from the actuator, control relay and body side wire harness.

SST 09990 – 00150, 09990 – 00200, 09990 – 00210, 09990–00370

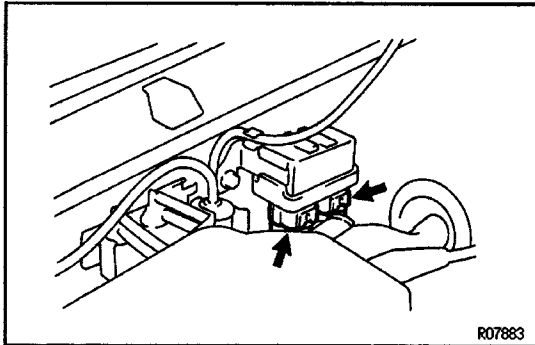

## 9. CONNECT CONNECTORS

(a) Connect the 2 connectors to the control relay.

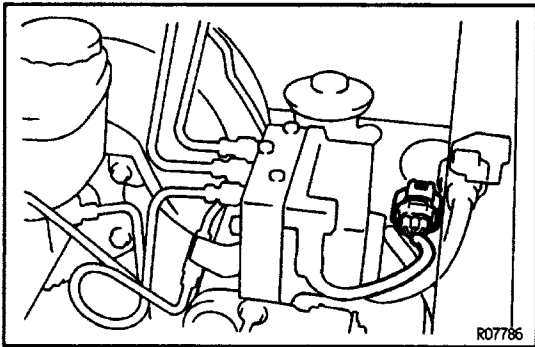

(b) Connect the connector to the actuator.

## 10. CLEAR DIAGNOSTIC TROUBLE CODES

(See page [BR-80](#))