





INSTRUMENT PANEL COMPONENTS

Code	Shape	Size	Code	Shape	Size	Code	Shape	Size
A		$\phi = 5$ (0.20) L = 14 (0.55)	B		$\phi = 6$ (0.24) L = 22 (0.87)	C		$\phi = 5$ (0.20) L = 18 (0.71)
D		$\phi = 5$ (0.20) L = 16 (0.63)	E		$\phi = 5$ (0.20) L = 16 (0.63)			



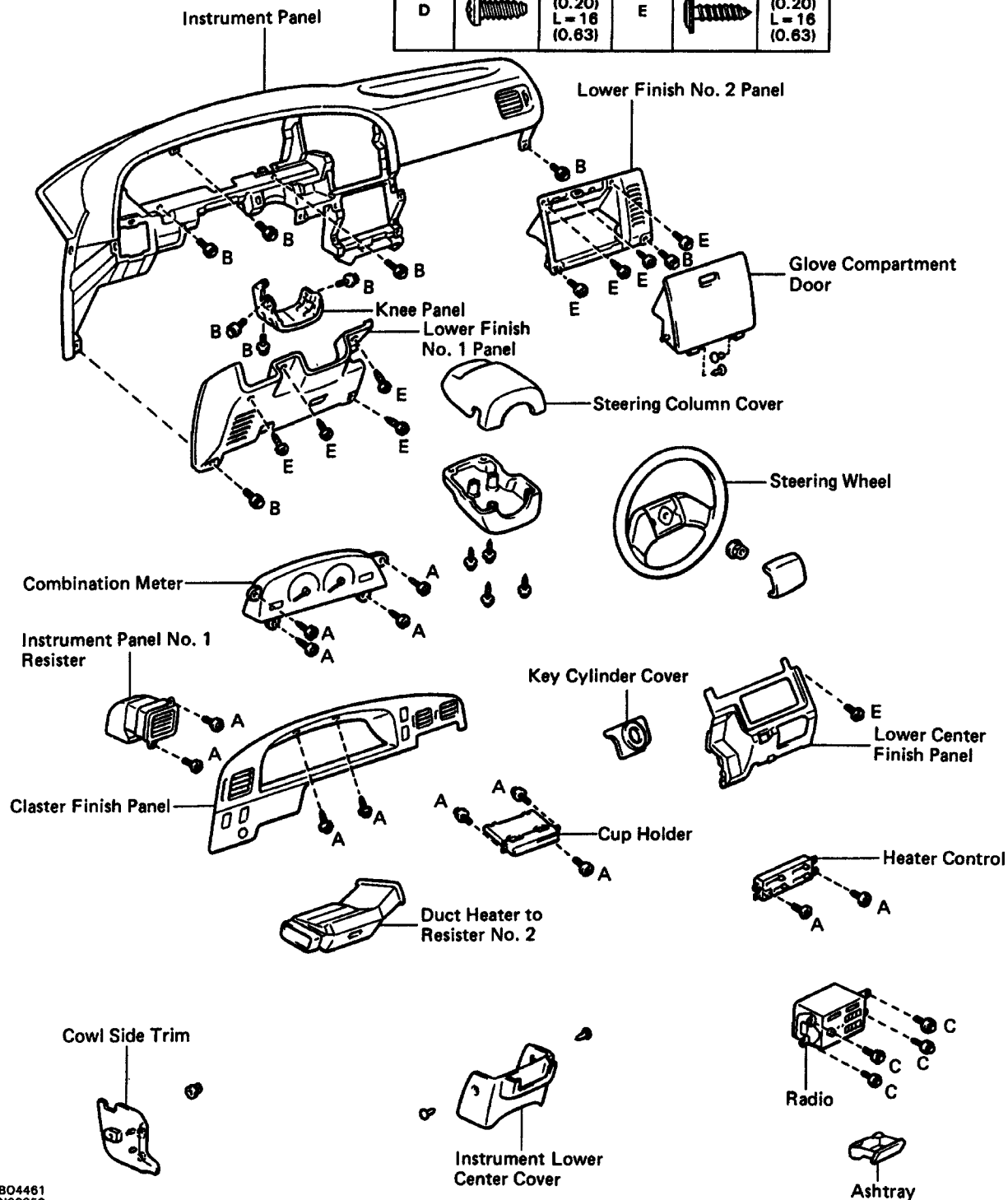
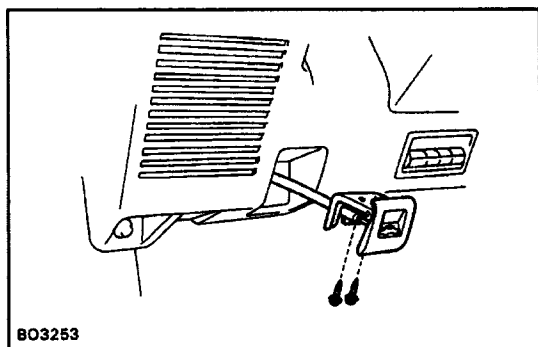

INSTRUMENT PANEL REMOVAL

1. DISCONNECT BATTERY CABLE FROM NEGATIVE (-) TERMINAL

2. REMOVE STEERING WHEEL

(See page [SR-6](#))

3. REMOVE STEERING COLUMN COVERS

4. REMOVE ENGINE HOOD RELEASE LEVER

Remove the 2 screws and the engine hood release lever.

5. REMOVE COWL SIDE TRIM

Remove the nut and the cowl side trim.

6. REMOVE INSTRUMENT LOWER CENTER COVER

Remove the 2 clips and the cover.

7. REMOVE KEY CYLINDER COVER

Pry out the key cylinder cover.

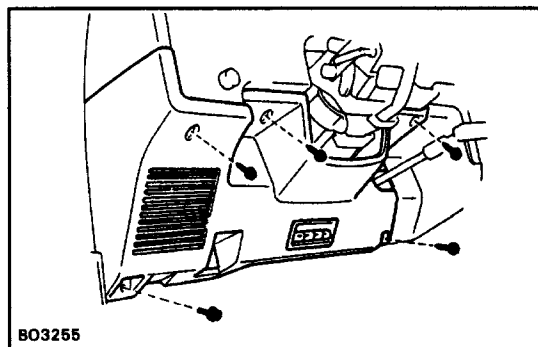
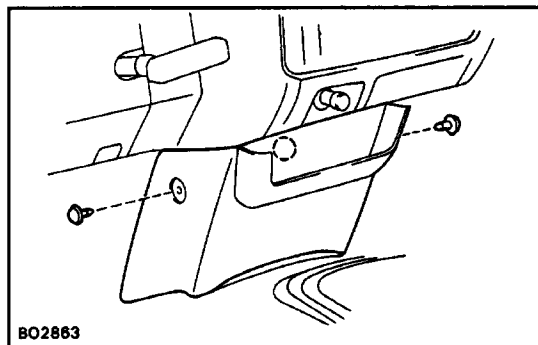

8. REMOVE LOWER FINISH NO. 1 PANEL

(a) Remove the 4 screws, the bolt and the panel.

(b) Disconnect the connector.

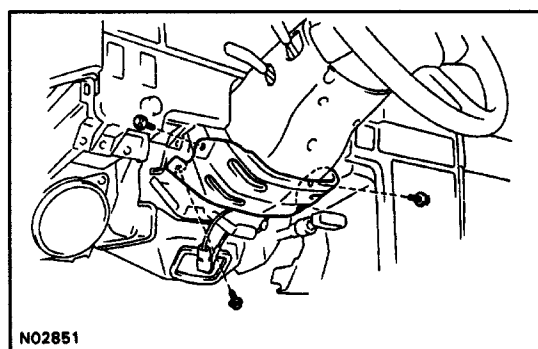

9. REMOVE KNEE PANEL

Remove the 3 bolts and the cover.

10. REMOVE DUCT HEATER TO RESISTER NO. 2

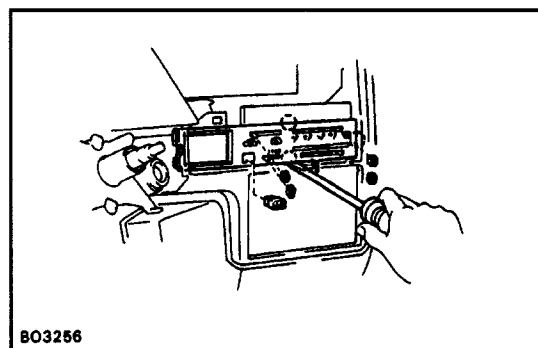

11. REMOVE HEATER CONTROL PLATE

(a) Pull off the heater control knobs.

(b) w/ A/C:

Pry off the A/C switch.

(c) Using a screwdriver, pry out the heater control plate, as shown in the illustration, and remove it.

HINT: Tape the screwdriver tip before use.

(d) w/ Clock:

Disconnect the connector.

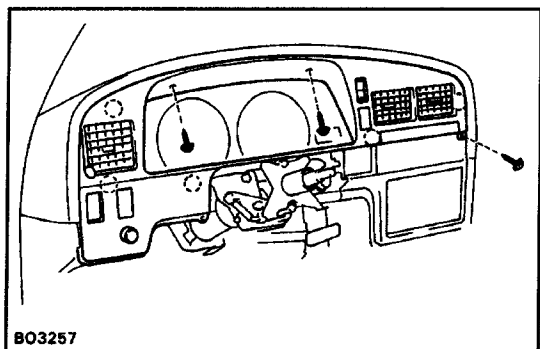

12. REMOVE CLUSTER FINISH PANEL

- (a) Remove the 3 screws and pull out the cluster finish panel.
- (b) Disconnect the connectors.
- (c) Remove the 2 screws and the cup holder from the cluster finish panel.

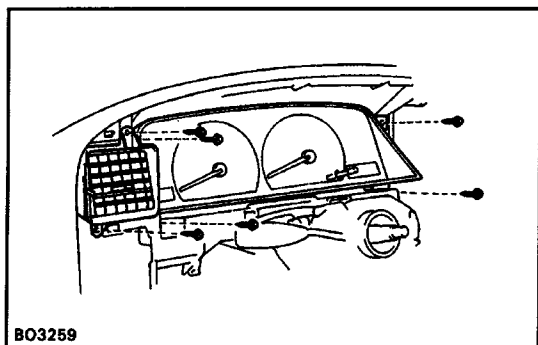

13. REMOVE INSTRUMENT PANEL NO. 1 REGISTER

Remove the 2 screws and the register.

14. REMOVE COMBINATION METER

- (a) Remove the 4 screws.
- (b) Disconnect the connectors and speedometer cable.
- (c) Remove the combination meter.

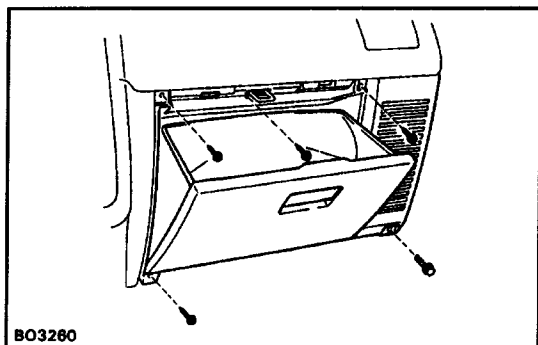

15. REMOVE LOWER FINISH NO. 2 PANEL WITH GLOVE COMPARTMENT DOOR

- (a) Remove the 4 screws, the bolt and the lower finish No. 2 panel with glove compartment door.
- (b) Disconnect the connector.

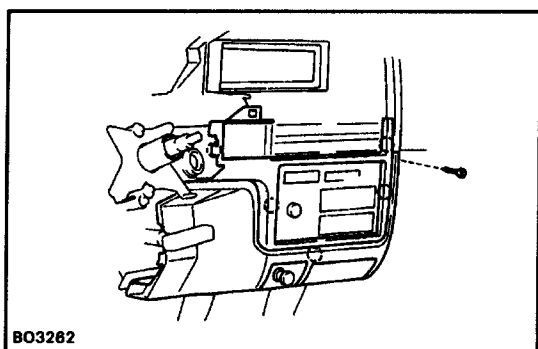

16. REMOVE LOWER CENTER FINISH PANEL

- (a) Remove the screw and pull out the panel.
- (b) Disconnect the connectors.

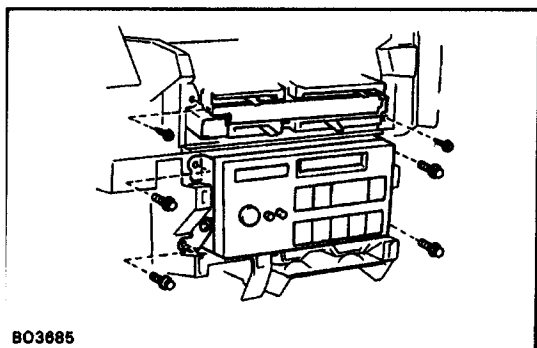

17. REMOVE HEATER CONTROL

Remove the 2 screws and hang the heater control.

18. REMOVE RADIO

- (a) Remove the 4 screws.
- (b) Disconnect the antenna cable and connectors.
- (c) Remove the radio with bracket.

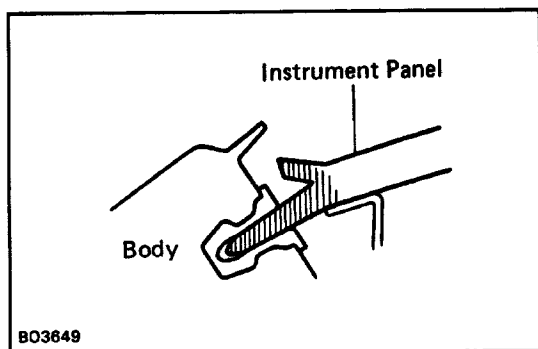

19. REMOVE INSTRUMENT PANEL

- (a) Remove the 4 bolts and the instrument panel.
- (b) Disconnect the connectors.

HINT: The instrument panel has a boss onto the clip on the body side. Therefore when removing, pull upward at an angle.

20. REMOVE THESE PARTS FROM INSTRUMENT PANEL

- (a) Safety pad
- (b) No. 3, No. 5 heater to register ducts
- (c) Instrument panel No. 2 register
- (d) Center bracket
- (e) Cowl bracket

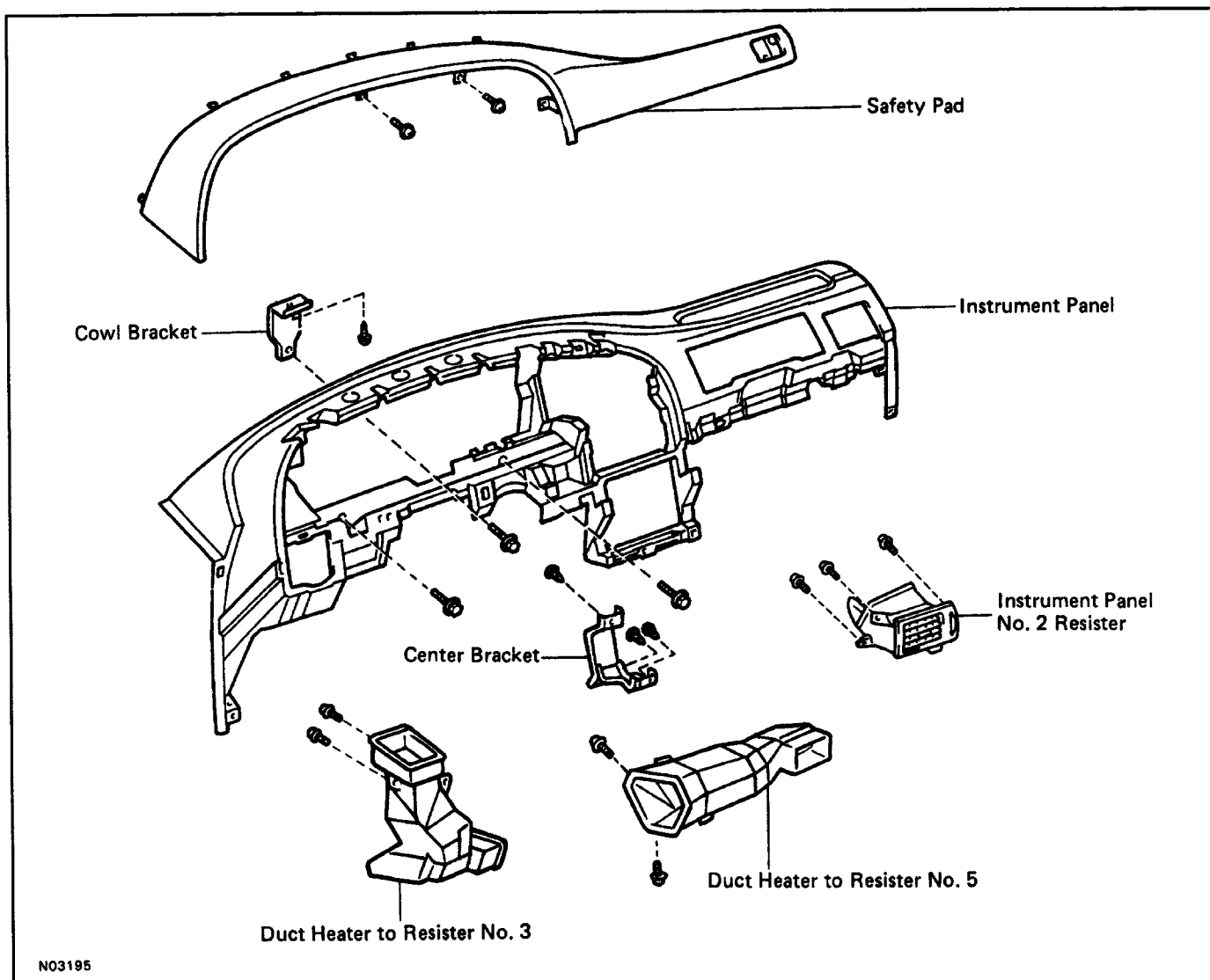

INSTRUMENT PANEL INSTALLATION

**INSTALL INSTRUMENT PANEL PARTS FOLLOW-
ING REMOVAL SEQUENCE IN REVERSE**